

WMP

VIDEO MOUNT PRODUCTS

Instruction Sheet For:

PDS-LFT & PDS-LFTB

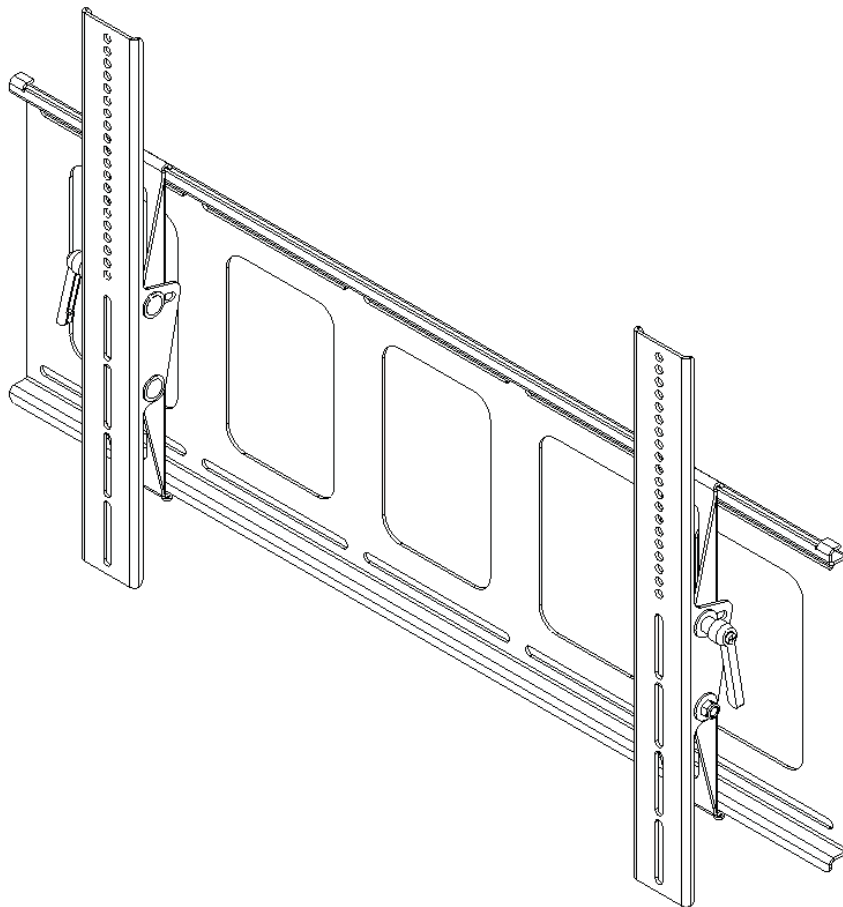

For more information, please contact us at:
345 Log Canoe Circle, Stevensville, Maryland 21666
Toll Free: 877.281.2169 Phone: 410.643.6390 Fax: 410.643.6615
www.videomount.com

PDS-LFT

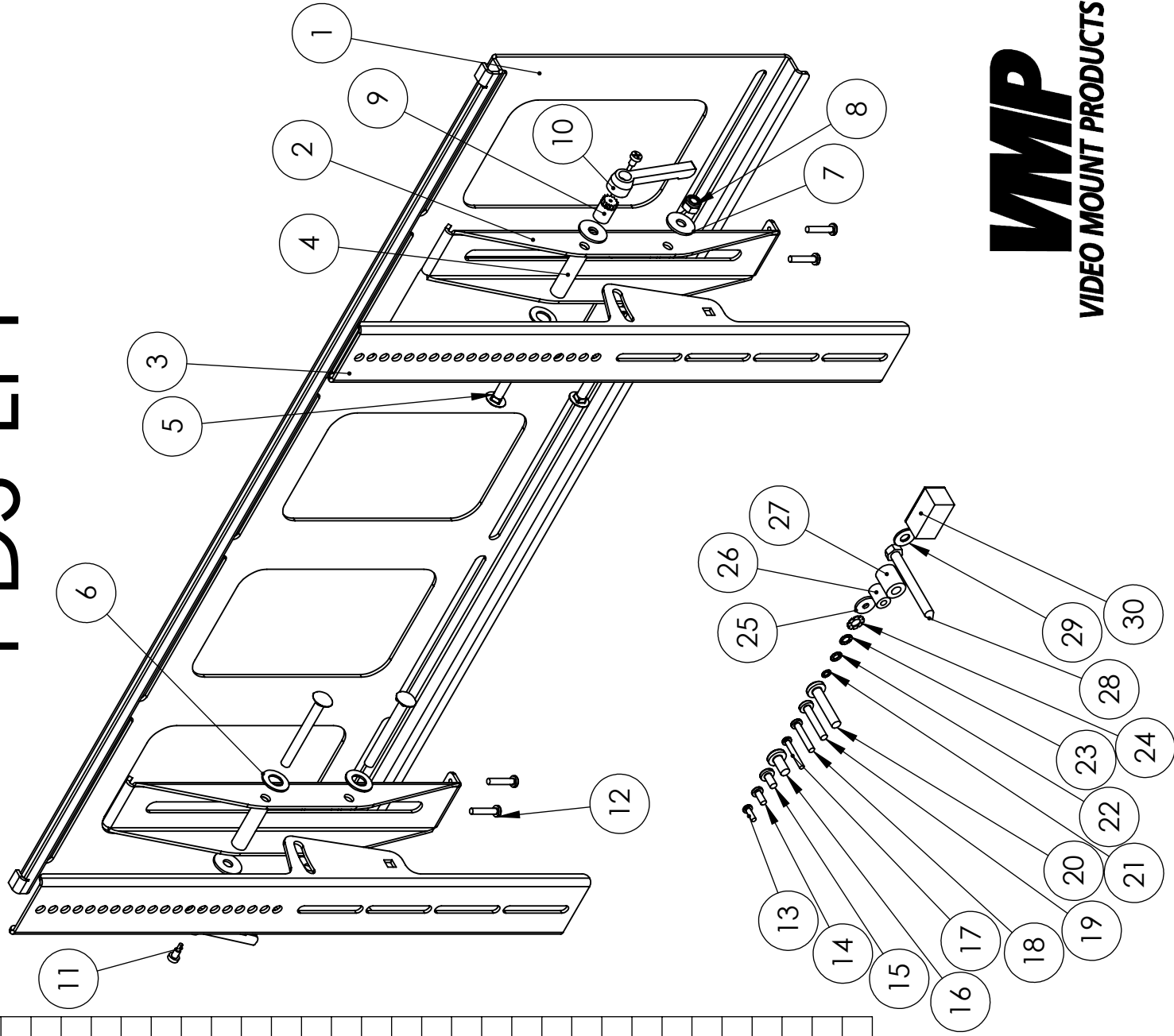

ITEM NO.	DESCRIPTION	QTY.
1	Wall Plate	1
2	Tilt Plate	2
3	Screen Mounting Bracket	2
4	Metal Spacer	2
5	Screw M8*P1.25*L75	4
6	Washer $\phi 13*\phi 24*T1.6$	4
7	Washer $\phi 8.5*\phi 25*T2.0$	4
8	Nylon Nut M8*P1.25	2
9	Gear Nut	2
10	Lever Handle	2
11	Lever Screw	2
12	Screw M5*P0.8*L25	4
13	Screw M4*P0.7*L12	4
14	Screw M5*P0.8*L12	4
15	Screw M6*P1.0*L12	4
16	Screw M8*P1.25*L16.5	4
17	Screw M4*P0.7*L30	4
18	Screw M5*P0.8*L30	4
19	Screw M6*P1.0*L35	4
20	Screw M8*P1.25*L40	4
21	Lock Washer M4	4
22	Lock Washer M5	4
23	Lock Washer M6	4
24	Lock Washer M8	4
25	Washer $\phi 5.5*\phi 18*T2$	4
26	Spacer M6	4
27	Spacer M8	4
28	Lag Screw 5/16"*2.5"	6
29	Washer $\phi 8.3*\phi 19*T1.6$	6
30	Magnetic Level	1

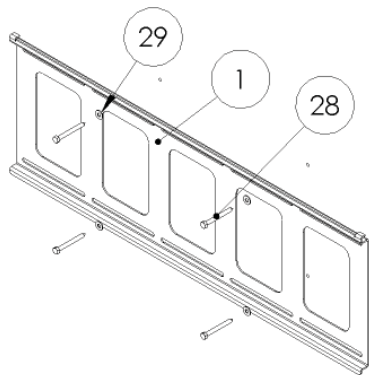

Step 2 : Attaching the wall plate to the wall

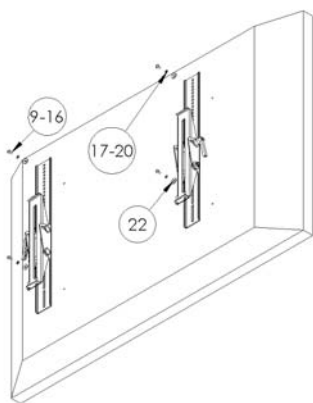

Step 3A: Attaching the mounting rails (holes are not recessed)

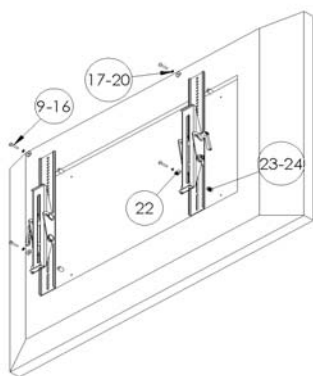

Step 3B: Attaching the mounting rails (holes are recessed)

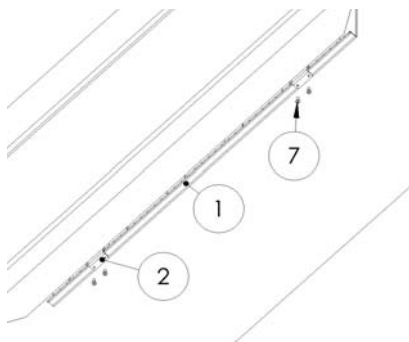

Step 4 : Attaching the mounting rails to the wall plate

Step 1

Before starting, lay out all parts to your mount and match them to the parts list provided. Verify that you have all your parts before attempting to assemble the mount.

Step 2

Mark the wall or desired mounting surface in preparation of installation of wall plate (1). If mounting to wooden studs, pre drill pilot holes using a 7/32" drill bit. Attach the wall plate (1) to the wooden stud using the 5/16" by 2.5" long lag screw (28) and washer (29) making sure the small ear flaps are on the top rail of the wall plate (1). **WARNING: Please verify that your mounting surface will support the combined weight of your mount, mounting hardware, and flat panel. Also verify that the mounting surface is safe to drill through. Please note only mounting hardware for mounting to wooden studs will be provided with the unit. If mounting to a surface other than wooden studs then other hardware will be required. If in doubt or uncertain about any of the above, please contact a professional installer.**

Step 3

Determine the correct screw size and if you need to use washers, lock washers, or spacers. **Note: Spacers are used for TVs with recessed hole patterns.** Secure the TV to the screen mount bracket (3) using the appropriate hardware (13) through (27). **Note: The brackets have to be level with each other to work properly..**

Step 4

Use the hooks in the wall pivot bracket (2) to hook on the top rail of the wall plate (1). Use the M5 screws (12) to secure the flat panel to the wall plate (1) and to secure its horizontal position.

Step 5

To adjust tilt, loosen the handles (10) and grasp the top and bottom of the flat panel and pull the flat panel into position. After achieving desired tilt retighten the handles. If obstruction prevents full rotation of the handle pulling out the handle will allow rotation of handle without affecting the tension of the mount. Push the handle back down when to wish to adjust the tension further. Use this ratcheting motion to tighten the tilt mechanism.

Please verify that all nuts and screws are securely tightened.



Enjoy Your Mount!

WARNING: The installer of these products must verify that the mount surface, ceiling or wall, will safely support the combined weight of all attached equipment and hardware. Video Mount Products will not be held liable for the improper use or installation of its products.