

VMP

VIDEO MOUNT PRODUCTS

Instruction Sheet For:

LCD-PV

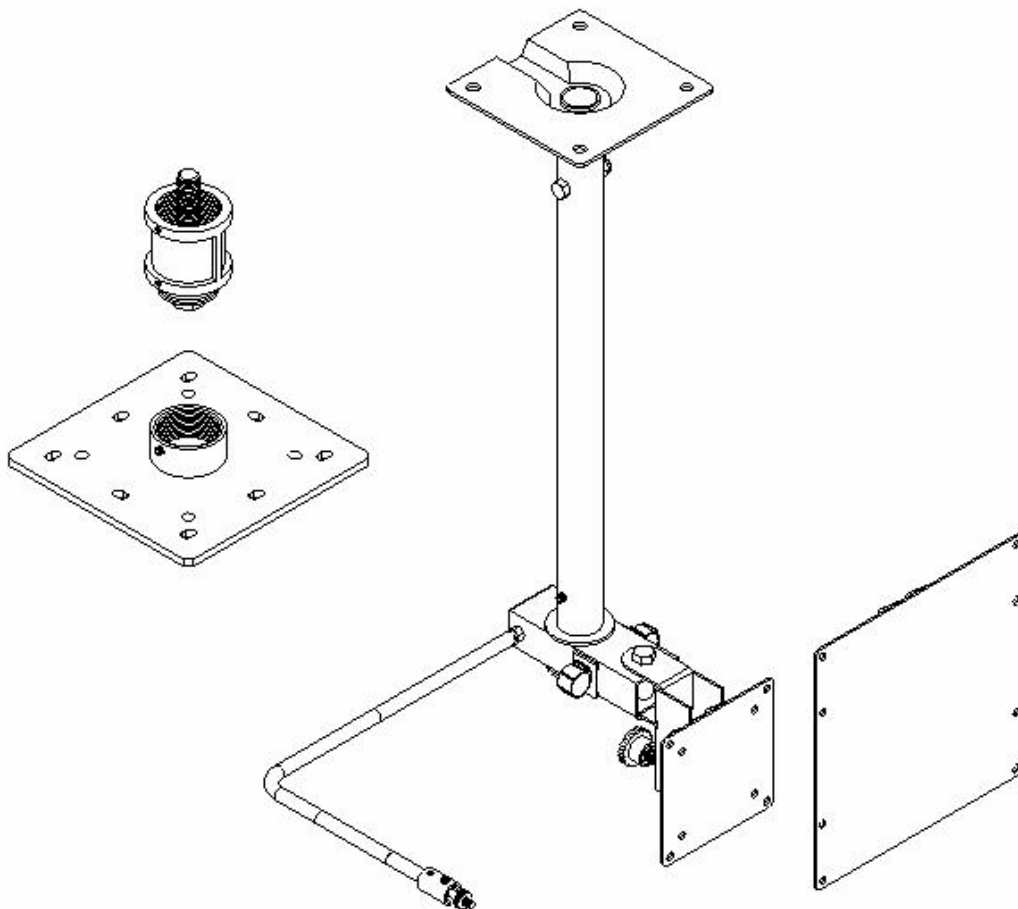

For more information, please contact us at:
345 Log Canoe Circle, Stevensville, Maryland 21666
Toll Free: 877.281.2169 Phone: 410.643.6390 Fax: 410.643.6615
www.videomount.com

ITEM NO.	DESCRIPTION	QTY.
1	Ceiling Plate	1
2	Extension Tube	1
3	Support Tube	1
4	Swivel Bracket	1
5	Small Mounting Plate	1
6	Large Mounting Plate	1
7	Nylon Nut M6*P1.0	1
8	Nylon Nut 3/8" - 16UNC	1
9	Screw M6*P1.0*L40	1
10	Screw 3/4"-16UNF*L74	1
11	Washer ϕ 3/4" * ϕ 46	2
12	Adjustable Screw 3/8"-16UNC*L68mm	1
13	Cable Clip	2
14	End Plug	1
15	Washer ϕ 3/8" * ϕ 19*T1.6	2
16	Screw 3/8" - 16UNC*L2"	1
17	Brake Screw 1/4" - 20UNC*L1 1/2"	1
18	Screw 5/16" - 18UNC*L1.75"	1
19	Nylon Nut 5/16" - 18UNC	1
20	M3 Allen Key	1
21	Screw M5*P0.8*L12	4
22	Screw M4*P0.7*L12	4
23	Thin Nut M8*P1.25	1
24	L Connector	1
25	Connector (L=85)	1
26	Connector (L=45)	1
27	Round Metal	1
28	Screw 1/4" - 20UNC	1
29	Swivel Metal	1
30	Nut 1/4" - 20UNC	1
31	Brake Screw M6*P1.0*L6	2
32	Connector (L=150)	1
33	Screw M6*P1.0*L12	4
34	Hex Nut 5/8" - 11UNC	1
35	Lock Washer 5/8"	1
36	Brake Screw 1/4" - 20UNC*L3/8"	3
37	Nut 1-7/8" - 12UNC	1
38	Screw 1-7/8" - 12UNC	1
39	Washer ϕ 44.5 * ϕ 17.5*T2.5	1
40	Gap Washer ϕ 44.5 * ϕ 17.5*T2.5	1
41	Screw 5/8" - 11UNC*L4"	1
42	CP-1	1
43	Lag Screw 5/16" * L2.5"	4
44	Washer ϕ 8.3 * ϕ 19*T1.6	4

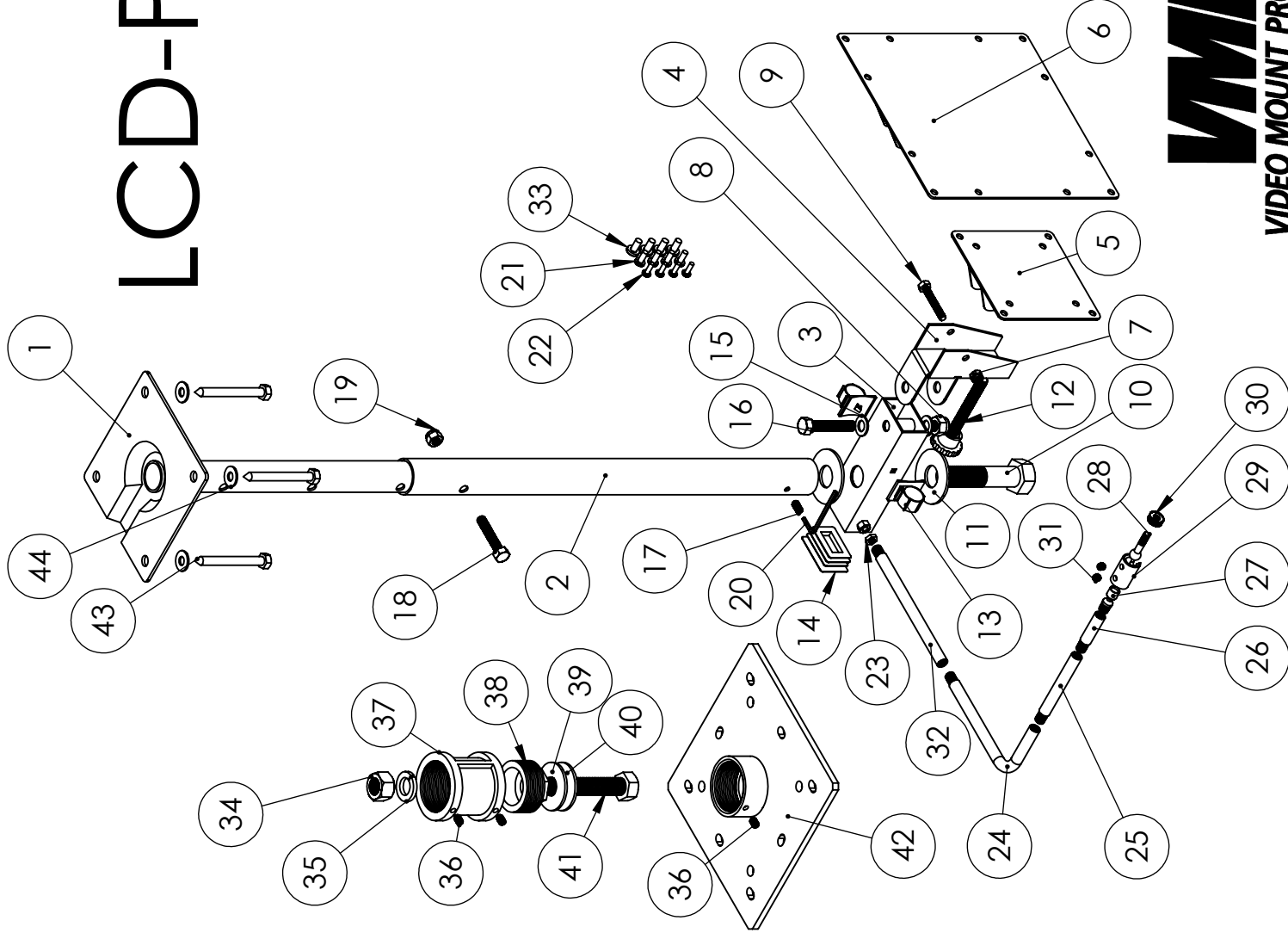

LCD-PV

VMP
VIDEO MOUNT PRODUCTS

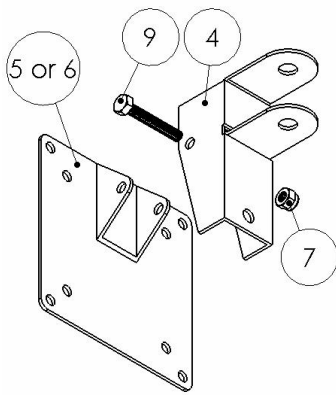

Step 2 : Selecting the correct mounting plate

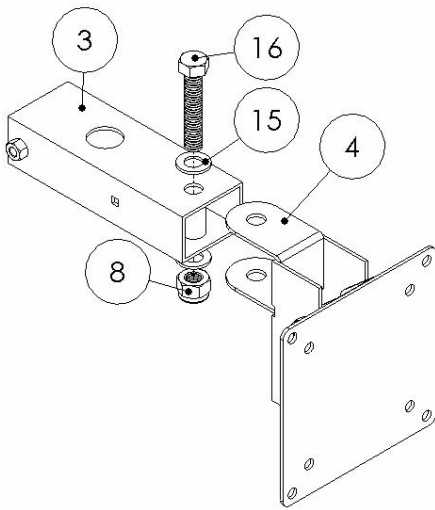

Step 3: Attaching the pivot bracket

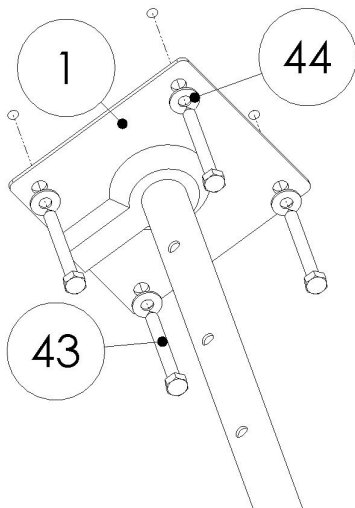

Step 4: Mounting the ceiling plate

Step 1

Before starting, lay out all parts to your mount and match them to the parts list provided. Verify that you have all your parts before attempting to assemble the mount.

Step 2

Determine the VESA standard that your TV follows to determine which VESA plate you will be using. For VESA 75 or 100 use the small mounting plate (5) and for VESA 200 or 100x200 use the large mounting plate (6). Once you have determined the correct VESA plate for your TV, attach the plate (5) or (6) to the pivot bracket (4) using an M6 screw (9) and nylon nut (7).

Step 3

Attach the swivel bracket (4) to the support tube (3) using the 3/8 inch screw (16), washers (15) and nylon nut (8). Insert the adjusting screw (12) into the back of the pivot bracket (4) for use when tilting the monitor.

If you plan to use the ceiling mast:

Step 4

Mark the ceiling or desired mounting surface in preparation of installation of ceiling plate (1). If mounting to wooden ceiling joists, pre drill pilot holes using a 7/32 inch drill bit. Attach the ceiling plate (1) to the wooden ceiling joist using the 5/16 inch by 2.5 inch long lag screw (43) and washer (44). **WARNING: Please verify that your mounting surface will support the combined weight of your mount, mounting hardware, and flat panel. Also verify that the mounting surface is safe to drill through. Please note only mounting hardware for mounting to wooden ceiling joists will be provided with the unit. If mounting to a surface other than wooden ceiling joists then other hardware will be required. If in doubt or uncertain about any of the above, please contact a professional installer.**

Step 5

Attach the extension tube (2) to the support tube (3) using the 3/4 inch bolt (10) and washers (11). Then screw the longer 1/4 inch brake screw (17) into the extension tube (2) so that it is tight against the 3/4 inch bolt (10). This will prevent the 3/4 inch bolt (10) from turning loose within the extension tube (2).

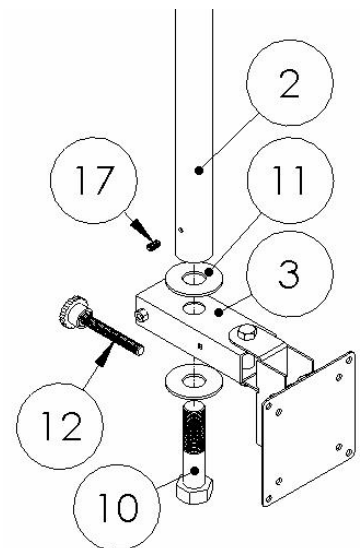

Step 5(Right) : Attaching the extension tube

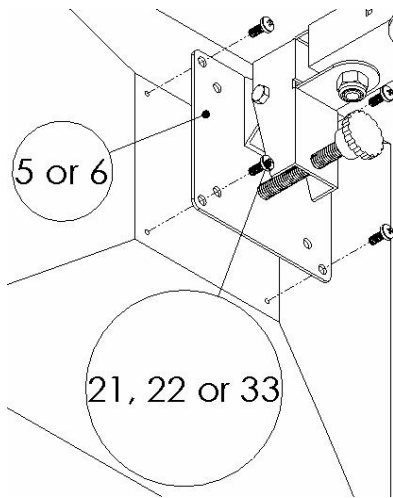

Step 6: Attaching the monitor
(monitor not included)

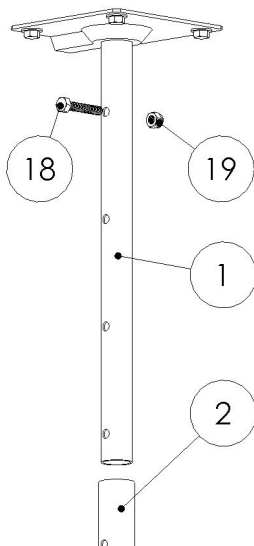

Step 7: Connecting the ceiling
plate and the extension tube

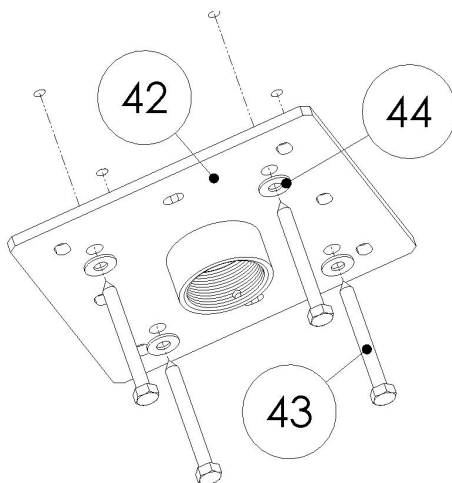

Step 8: Mounting the ceiling plate

Step 6

Attach your monitor to the chosen mounting plate (5) or (6) using the M4 (21) , M5 (22) or M6 (33) screws as appropriate.

Step 7

Connect the extension tube (2) to the ceiling plate (1) using the 5/16" screw (18) and nylon nut (19) . Proceed to step 12

If you plan to use 1.5" NPT as a ceiling mast:

Step 8

Mark the ceiling or desired mounting surface in preparation of installation of ceiling plate (42) . If mounting to wooden ceiling joists, pre drill pilot holes using a 7/32" drill bit. Attach the ceiling plate (42) to the wooden ceiling joist using the 5/16" by 2.5" long lag screw (43) and washer (44) . **WARNING: Please verify that your mounting surface will support the combined weight of your mount, mounting hardware, and flat panel. Also verify that the mounting surface is safe to drill through. Please note only mounting hardware for mounting to wooden ceiling joists will be provided with the unit. If mounting to a surface other than wooden ceiling joists then other hardware will be required. If in doubt or uncertain about any of the above, please contact a professional installer.**

Step 9

Attach the female pipe couple (37) , (38) & (36) to the top of the support tube (3) using the 5/8" screw (41) , washers (39) & (40) , spring washer (35) and hex nut (34) .

Step 10

Attach your monitor to the chosen mounting plate (5) or (6) using the M4 (21) , M5 (22) or M6 (23) screws as appropriate.

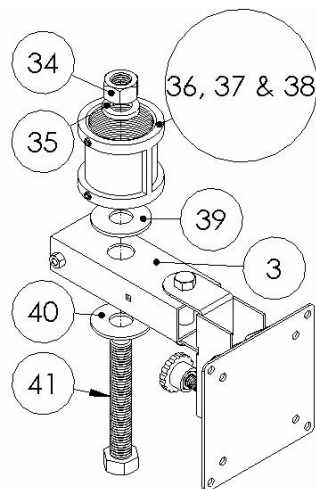

Step 9: Attaching the female
pipe couple

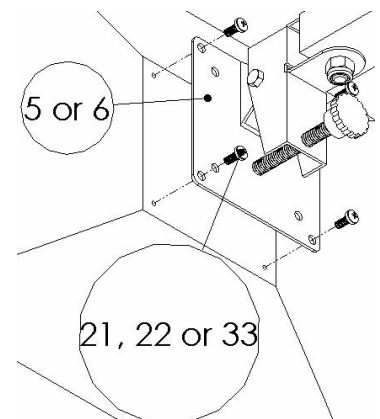

Step 10: Attaching the monitor
(monitor not included)

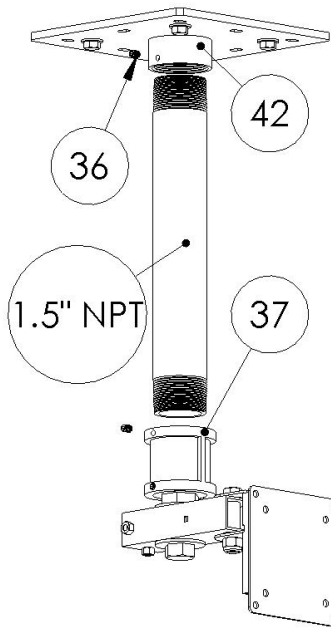

Step 11 : Inserting the 1.5" NPT
(monitor not shown for clarity)

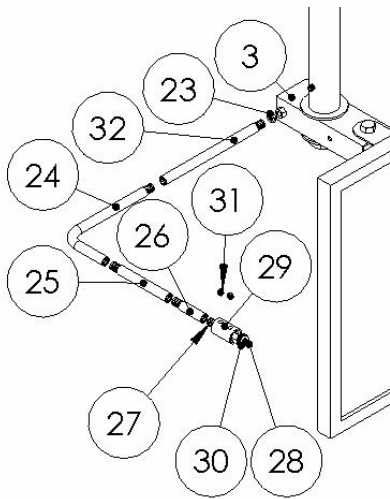

Step 12: Using the camera
bracket

Step 11

Screw in the 1.5" NPT pipe into the top of the female pipe couple (37) and the ceiling plate (42) . Screw 1/4" brake screws (36) into the top of the female pipe couple (37) and ceiling plate (42) so the brake screws are tight against the pipe. This will help prevent the pipe from turning out of the pipe couples.

Step 12

If you desire to use the camera bracket then follow this step, otherwise proceed to the next step. First determine if you wish the camera to be mounted below or to the side of the monitor. Then determine how long the camera arm needs to be to extend past the side or bottom of the monitor. Use the connectors provided (25) , (26) & (32) to extend the L connector (24) as needed. Take the end assembly (27) , (28) , (29) , (30) & (31) and screw it to the connector (24) , (25) , (26) or (32) furthest from the center of the mount. Make sure the M6 brake screws (31) are tight in the swivel metal (29) .

Step 13

Attach your monitor to the chosen mounting plate (5) or (6) using the M4 (21) , M5 (22) or M6 (33) screws as appropriate.

Please verify that all nuts and screws are securely tightened.



Enjoy Your Mount!

WARNING: The installer of these products must verify that the mount surface, ceiling or wall, will safely support the combined weight of all attached equipment and hardware. Video Mount Products will not be held liable for the improper use or installation of its products.