

# **WMP**

VIDEO MOUNT PRODUCTS

*Instruction Sheet For:*

## **EXT Series**

---

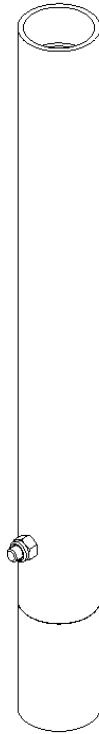

---

*For more information, please contact us at:*  
345 Log Canoe Circle, Stevensville, Maryland 21666  
Toll Free: 877.281.2169 Phone: 410.643.6390 Fax: 410.643.6615  
[www.videomount.com](http://www.videomount.com)

# EXT-Series

ITEM NO.	DESCRIPTION	QTY.
1	Outer Mast	1
2	Inner Mast	1
3	Hex Screw 5/16"-18UNC*L2.5"	1
4	Nylon Nut 5/16"-18UNC	1

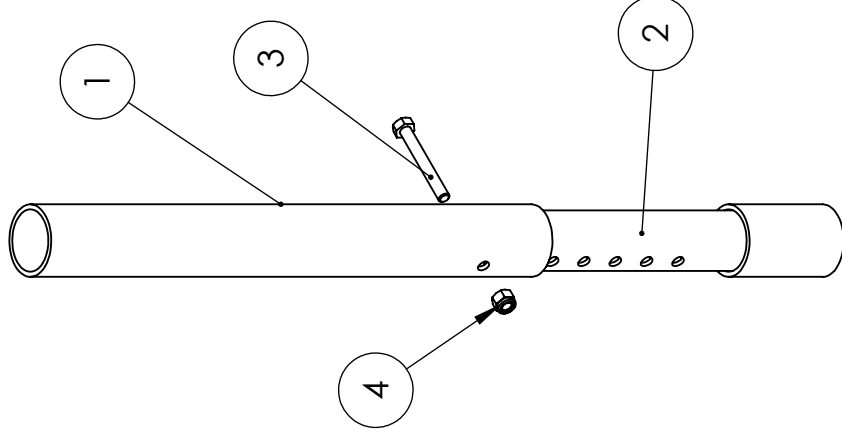

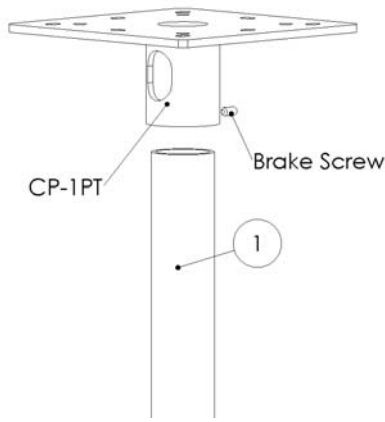

Step 2: Securing the outer mast

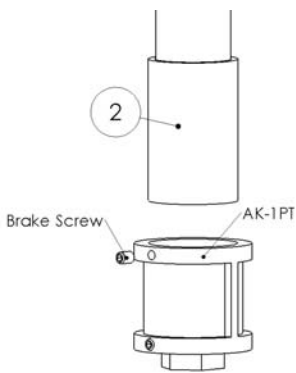

Step 3: Securing the inner mast

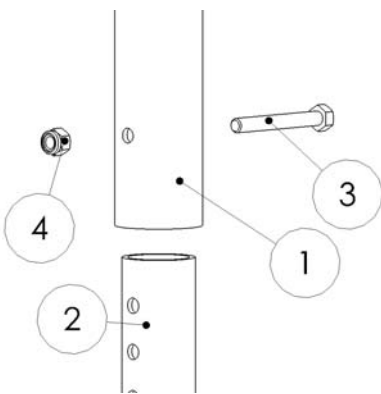

Step 4: Attaching the two masts

### Step 1

Before starting, lay out all parts to your mount and match them to the parts list provided. Verify that you have all your parts before attempting to assemble the mount. **Note: These instructions are written for VMP products. If using another manufacturer's product that uses a different method of securing pipe please refer to that manufacturer's specifications as to how to properly secure the pipes into the pipe couples.**

### Step 2

Take the outer mast (1) and thread it into the female pipe couple attached to the mounting surface. The VMP model CP-1PT is used in image. Tighten the outer mast (1) into the pipe couple until you can no longer turn the mast. Tighten brake screw provided with the ceiling plate into the outer mast (1) until you can no longer tighten it further.

### Step 3

Thread the inner mast (2) into the other desired female pipe couple, usually attached to the remainder of the mount. The VMP model AK-1PT is used in the images shown. Tighten the inner mast (2) into the pipe couple until you can no longer turn the mast. Tighten brake screw provided with the other pipe couple into the inner mast (2) until you can no longer tighten it further.

### Step 4

Choose the height at which you wish to have the ceiling mount at and line up the holes in the inner (2) and outer (1) masts. Pin the masts together using the 5/16" by 2.5" long screw (3) and secure by fastening the nylon nut (4) onto the end of the screw.

*Please verify that all nuts and screws are securely tightened.*



***Enjoy Your Mount!***

***WARNING: The installer of these products must verify that the mount surface, ceiling or wall, will safely support the combined weight of all attached equipment and hardware. Video Mount Products will not be held liable for the improper use or installation of its products.***